

Why is an air switch installed in the distribution box



Overview

Air switches are fundamental components in electrical power distribution systems. They provide a critical safety function by allowing operators to visibly confirm that a circuit is de-energized before any work is performed. In this blog post, we'll delve into what air break switches are, how they. An air break switch is a type of switch that makes use of air as a dielectric and arc quenching medium. 2□Lighting circuits generally use 10-16A small air switches.



Why is an air switch installed in the distribution box

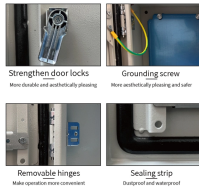

Air switch is used in our home, as long as the current in the circuit exceeds the rated current of the air switch, the air switch automatically disconnects and then cuts off the power supply. ...



Air break switches are extensively used in electrical distribution networks for switching and isolation purposes of distribution lines. They can be used for both switching and isolation.



Hubbell's airbreak switchgear is expertly designed to enhance the reliability and efficiency of power distribution systems. These switches are crafted to handle high electrical loads, ensuring smooth and ...



Air switches are fundamental components in electrical power distribution systems. They provide a critical safety function by allowing operators to visibly confirm that a circuit is de-energized ...



The above air switch installation is for reference only, the actual power of electrical appliances in each household is not the same, the specific design of the electrician shall prevail.



Electrical air break switches are indispensable in modern power systems, providing essential functions for isolating and protecting electrical circuits. Their role in ensuring the safety, ...



An Air Break Switch (ABS) is a vital component in medium to high voltage electrical systems. It plays a key role in isolating electrical circuits, especially in overhead transmission and ...

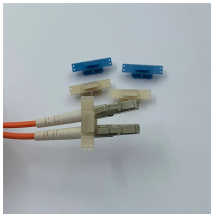

Air break switches are generally installed in the distribution networks as a ...

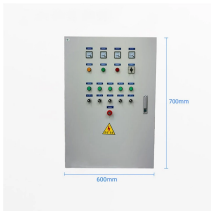

1) An air switch is a type of circuit breaker that uses air to extinguish the arc that forms when it opens the circuit. It automatically disconnects the circuit when the current exceeds the rated level to prevent ...



The air break switch is mostly installed in the distribution network as a switching point. It interrupts the small excitation current of a transmission line or the capacitive charging current.



Air break switches are generally installed in the distribution networks as a switching point to make or break connections between cables, transformers, and other high voltage electrical devices.

Contact Us

For more information, pricing, or custom data center solutions, please contact us:

Website: <https://www.yoahorroenergia.es>

Email: hello@yoahorroenergia.es

Phone: +233 54 318 7269

Address: Plot 28, Spintex Road, Accra, Greater Accra, Ghana

This document is for informational purposes only. Specifications subject to change without notice.

