

Response time of relay protection device



Overview

The need to act quickly to protect circuits and equipment often requires protective relays to respond and trip a breaker within a few thousandths of a second. In some instances these clearance times are prescribed in legislation or operating rules. Digital protective relays are integral components in power systems, responsible for detecting faults and initiating protective actions to safeguard equipment from damage. The relay curve is shown as the dark blue line. This additional time is. Time-Current Characteristics, also known as TCC curves or time-current curves, play a significant role in relay protection coordination within electrical power networks.

Response time of relay protection device



A response is a reaction to a question, experience, or some other type of stimulus. If you cry at sad movies, you're having an emotional response to the drama that's taking place on the screen.

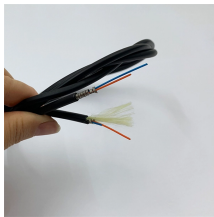

A response is a reaction to a question, experience, or some other type of stimulus. If you cry at sad movies, you're having an emotional response to the drama that's taking place on the screen.



When you ask for a response, you are asking somebody to give you something. To better demonstrate this, it is worth imagining the "response" as being something that can physically be given (although, a ...



In these cases, the use of inverse time relays in favor of definite time relays can usually speed up the operating time of the protection at high fault current magnitudes.



All of the following operational timeframes are taken into account into the minimum time interval between the relay characteristics: It takes at least 0.4 seconds for the relay to activate, the ...



Protective relays and devices have been developed over 100 years ago to provide “lastline” of defense for the electrical systems. They are intended to quickly identify a fault and isolate it so the balance of ...



What is another word for response? A response is a reply or an answer —something said or done after someone else has said or done something. Like response, reply and answer can be used in the ...



response may imply a quick or spontaneous reaction to a person or thing that serves as a stimulus.

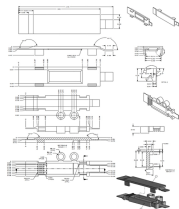

Response time refers to the duration a relay takes to detect a fault and initiate a trip signal to open a circuit breaker. In high-stakes environments like power systems, minimizing ...

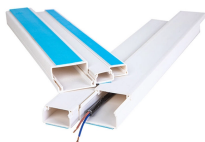

1. The act of responding. 2. A reply or an answer. 3. A reaction, as that of an organism or a mechanism, to a specific stimulus: a microphone's response to certain frequencies; response by the immune ...



The need to act quickly to protect circuits and equipment often requires protective relays to respond and trip a breaker within a few thousandths of a second. In some instances these clearance times are ...



This paper describes a practical method for improving relay coordination for high current faults by reducing the relay operating times by integrating the relay functions. This results in reduced fault ...

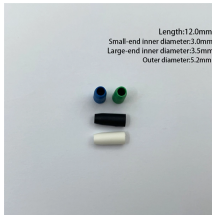

Digital devices introduce an attribute of embedded firmware, which must be analyzed for reliability performance in addition to the hardware. This paper provides a detailed analysis of accepted ...



Action time, as an important indicator to measure the response speed of relay protection devices, reflects the duration from the input of fault signals to the ...



Your response to an event or to something that is said is your reply or reaction to it. In response to my question, he lifted his head and thought for a moment.



Responce or response? Learn the correct spelling, meaning, origin, examples, and global usage differences in this simple guide.



an action done as an answer to another action: a friendly response to his greeting. She nodded in response to his greeting. Biology behavior of a living thing due to a ...



These relays operate when the current exceeds the pick-up value after a set time delay. The time delay settings are adjustable and set following an overcurrent coordination study.



These curves illustrate the response time of a specific protective device, such as a circuit breaker or a protective relay, to different levels of faults or abnormal conditions within the power system.



Relay curves show only the time for the relay itself to operate and do not include additional time required to trip and clear the fault. The relay curve is shown as the dark blue line.



Performance Tests: The standard includes test procedures for assessing the overall performance of relays, such as response time, coordination with other protection devices, and stability under ...



RESPONSE definition: 1. an answer or reaction: 2. any of the parts sung or said, in some religious ceremonies, by the.... Learn more.

Contact Us

For more information, pricing, or custom data center solutions, please contact us:

Website: <https://www.yoahorroenergia.es>

Email: hello@yoahorroenergia.es

Phone: +233 54 318 7269

Address: Plot 28, Spintex Road, Accra, Greater Accra, Ghana

This document is for informational purposes only. Specifications subject to change without notice.

