

Polarization-maintaining fiber optic patch cord assembly process



Overview

A common requirement in polarizing devices is a fiber optic patchcord assembly where two or more polarization maintaining fibers are terminated in a single ferrule, to be attached to a lens or other optical assembly. We offer a wide range of connector types, including FC, SC, LC, MTP, and E2000, as well as AR-coated variants. Hybrid terminated connectors enable users to adapt FC/PC or FC/APC patchcords for compatibility with existing fiber assemblies. Available from stock, these cables feature a high-quality polish, which leads to a typical return loss of 60 dB. Assembled in our facility, each cable is. Polarization-maintaining (PM) fibers are optical fibers that preserve the polarization state of light. PM fibers contain stress elements along their length that create two orthogonal axes with different indices of refraction.

Polarization-maintaining fiber optic patch cord assembly process

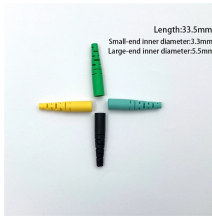

These polarization-maintaining fiber optic patch cables are terminated on both ends with narrow key, ceramic-ferrule FC/APC connectors. Available from stock, these cables feature a high-quality polish, ...



This high-performance Polarization Maintaining (PM) Fiber Patch Cord is engineered for precision-critical optical systems. Using Panda-type PM fibers and carefully aligned connectors, it ...



Berkshire Photonics offers its 53XX series of PM fiber patchcords (“jumpers”) in standard configurations and lengths as shown below. Each assembly is delivered with insertion loss and extinction ratio ...



Our advanced PM fiber alignment and low-stress bonding technology guarantee minimal angular misalignment and superior PER performance across the 405–1620 nm wavelength range.



Polarization Maintaining (PM) Patch Cords are made using specialty fiber that uses stress applying parts to make the light signal travel along a controlled path.



A common requirement in polarizing devices is a fiber optic patchcord assembly where two or more polarization maintaining fibers are terminated in a single ferrule, to be attached to a lens or other ...



Product features Slow Axis Alignment □ Polarization-maintaining fiber with a pair of FC/APC connectors □ Wavelength range of 400-2200 nm □ Narrow key (2 mm) and slow axis alignment □ ...

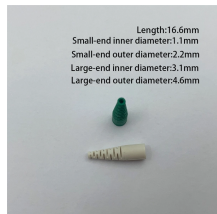

Length:16.6mm
Small-end inner diameter:1.3mm
Small-end outer diameter:2.2mm
Large-end inner diameter:3.1mm
Large-end outer diameter:4.6mm

FIBERWDM's Polarization Maintaining Fiber Patch Cord (PM Fiber Patch Cord) are available with FC, SC, LC connector options or as a pigtail assembly, center wavelength can be 780, 980, 1030, ...

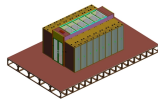

Hybrid terminated connectors enable users to adapt FC/PC or FC/APC patchcords for compatibility with existing fiber assemblies. Typical extinction ratios between 18 - 25dB maintain input polarization ...

Contact Us

For more information, pricing, or custom data center solutions, please contact us:

Website: <https://www.yoahorroenergia.es>

Email: hello@yoahorroenergia.es

Phone: +233 54 318 7269

Address: Plot 28, Spintex Road, Accra, Greater Accra, Ghana

This document is for informational purposes only. Specifications subject to change without notice.

