

Kyn28 High Voltage Switch Copper Tube Small Busbar

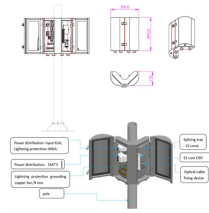

Kyn28 High Voltage Switch Copper Tube Small Busbar



KYN28-12 is suitable for 3.6 ~ 12KV three-phase AC 50Hz power grid, for accepting and distribution of electrical energy, and for purposes of the circuit controlling, monitoring and protection.



AC Metal-Enclosed Switchgear Overview KYN28-24 switchgear has a variety of functions to prevent misoperation, including preventing moving handcar with load, preventing grounding switch from ...



KYN28 indoor metal-clad withdrawable switchgear (hereafter short as switchgear) is a complete power distribution device for 3.6~24KV, 3 phase AC 50Hz, single bus sectionalized system.



Low-voltage Switchgear Bridge Support High-voltage Busbar Low-voltage Busbar Intelligent Bus Duct Prefabricated Cabin Box-type Substation High-voltage Switchgear

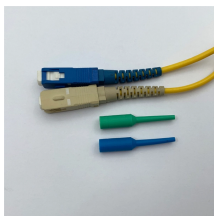

The company's products cover 6kv, 11kv, 22kv, 35kv, 220kv, etc. Power transformers, distribution transformers, box-type substations, high and low voltage switchgear, wind power, photovoltaic power ...



The utility model aims at providing a KYN28 high-voltage board bus-bar wiring design structure to solve the problem that proposes among the above-mentioned background art.



KYN28A-12 armored movable metal enclosed switchgear is suitable for three-phase AC 50Hz, 3.6-12kV single busbar and single busbar segmented power systems, and is used as a transmission control ...



The company's products cover 6kv, 11kv, 22kv, 35kv, 220kv, etc. ...



KYN28A-12 (Z) (GZS1) type armored withdrawable AC metal-enclosed switch device is a indoor complete set 3 phase AC power distribution device with rated voltage 3.6~12KV.



Adopting precision sheet metal technology, high-purity electrolytic copper materials, and standardized wiring processes, combined with strict factory inspections, we comprehensively ensure the product's ...



The switchgear is equipped with high-performance VS1 series medium-voltage AC vacuum circuit breakers and solid-sealed vacuum circuit breakers. The busbar adopts heat-shrinkable insulation ...



KYN28-12 indoor AC armored removable metal-enclosed switchgear is used in three-phase AC power system with rated voltage of 12kV and rated frequency of 50Hz for receiving and ...

Contact Us

For more information, pricing, or custom data center solutions, please contact us:

Website: <https://www.yoahorroenergia.es>

Email: hello@yoahorroenergia.es

Phone: +233 54 318 7269

Address: Plot 28, Spintex Road, Accra, Greater Accra, Ghana

This document is for informational purposes only. Specifications subject to change without notice.

